

THE DEVONSHIRE

PLAN #
2235



PLAN 2235 / ELEVATION "A"

FLOOR PLANS OTHER SIDE

Timber Truss Housing Systems, Inc. has caused some TrussMark plans to be copyrighted by the United States Copyright Office, Library of Congress, Washington, D.C. Unauthorized use of the TrussMark plan, without the permission of Timber Truss Housing Systems, Inc., can lead to an award of damages, reimbursement of attorney's fees and costs, and the seizure or destruction of all infringements under Title 17, United States Code. Copyright law protection extends beyond exact duplication. An unauthorized use which is substantially similar to the plan is copyright infringement.

DUPLICATION OF EVERY DETAIL OR EXACT COPYING IS NOT NECESSARY TO ESTABLISH INFRINGEMENT OF THE COPYRIGHT. MAKING MINOR CHANGES IN THE HOUSE PLAN IS NOT AN AUTHORIZED USE UNDER THE COPYRIGHT LAW. INFRINGEMENT OF COPYRIGHT CAN EXIST EVEN WHERE ONLY A PART IS COPIED.

**TrussMark Homes**
by TIMBER TRUSS HOUSING SYSTEMS, INC.

P.O. Box 996
Salem, Virginia 24153-0996
Phone **540/387-0273**
800/766-9072
Fax **540/389-0849**
www.timbertruss.com

Located at: **525 McClelland Street**
(at 4th Street Bypass/Truck Route)

WIDTH: 72'-0" DEPTH: 39'-5" LIVING AREA: 2,235 sq. ft.

Plan# **2235**

The Victorian influences and covered porch invite you to a truly beautiful home. This plan features: 3 large Bedrooms, formal Dining Room, Great Room with sloped ceiling, fireplace, window seat, bookshelves, and patio door leading to patio or deck. On the first floor, you'll also find a large Kitchen with an island and nook, a convenient study, laundry, and two-car garage. Upstairs you'll find the Master Suite prominently located and featuring a walk-in closet and large bath area.



UPPER LEVEL
Floor Plan

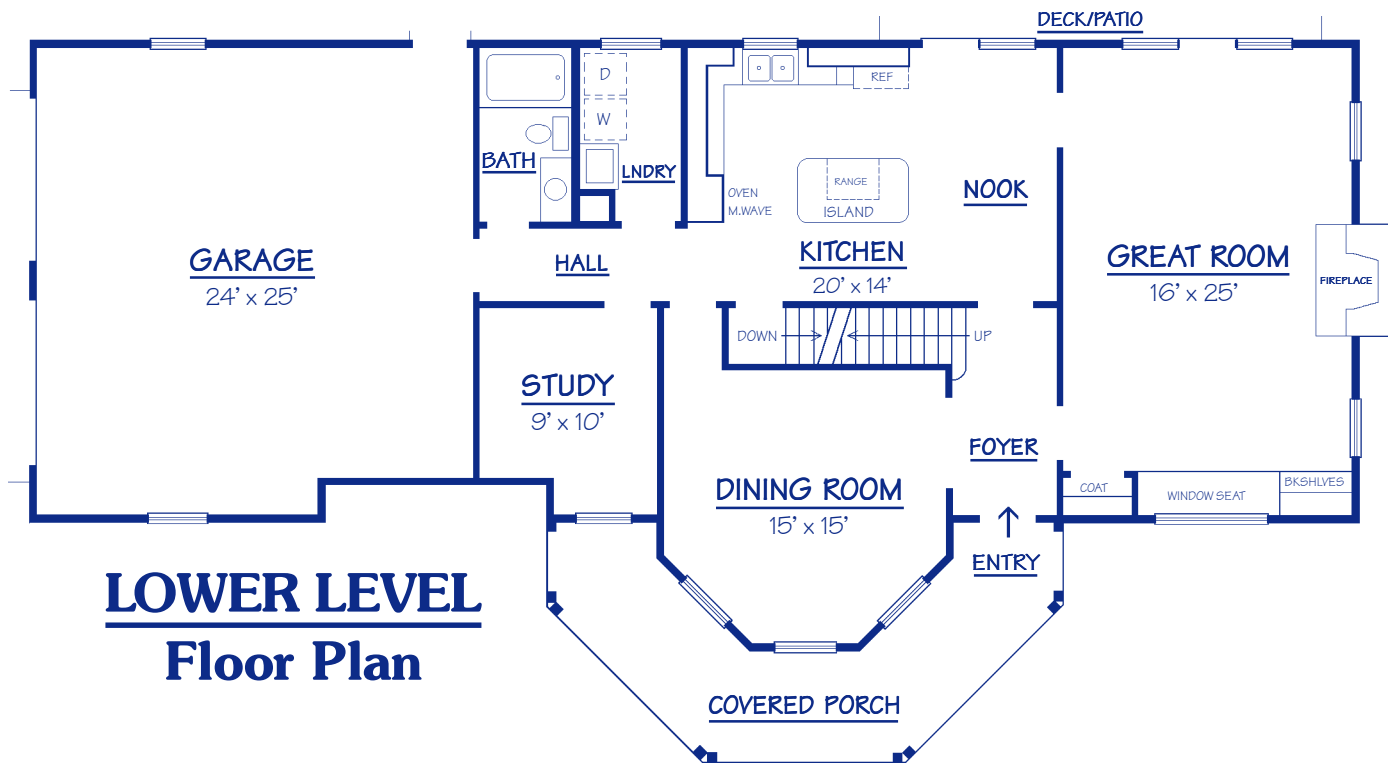

LOWER LEVEL
Floor Plan

PROPRIETARY INFORMATION:

The furnishing of this information does not convey any reproduction or construction rights.

This brochure is provided as general information for choosing your new home. Refer to blueprints and specifications for accurate details. Timber Truss Housing Systems, Inc. reserves the right to introduce changes in plans and specifications without notification or obligation.

TrussMark Homes
by **TIMBER TRUSS HOUSING SYSTEMS, INC.**
P.O. Box 996 • 525 McClelland Street
Salem, Virginia 24153-0996
Phone **540/387-0273** • Fax **540/389-0849**
www.timbertruss.com