

NEWEST TRUSSMARKS

THE WILSHIRE

PLAN #
2126

WIDTH: 44'-0" DEPTH: 52'-0" LIVING AREA: 2,126 sq. ft.- (includes 216 sq. ft. Bonus Room)



PLAN 2126 / ELEVATION "A"

The "Wilshire", Plan# 2126, is a feature-packed 3 Bedroom, 2-1/2 Bath home. The plan features a 2-Car Garage, Master Bedroom on the lower level, spacious Master Bath, closet and dressing area, and a dramatic balcony overlooking the Great Room with fireplace. A Covered Porch is found at both the front and rear of the home. Two Bedrooms are upstairs and also a Bonus Room. Lots of storage space is also incorporated in this lovely home.



Lower Level Floor Plan

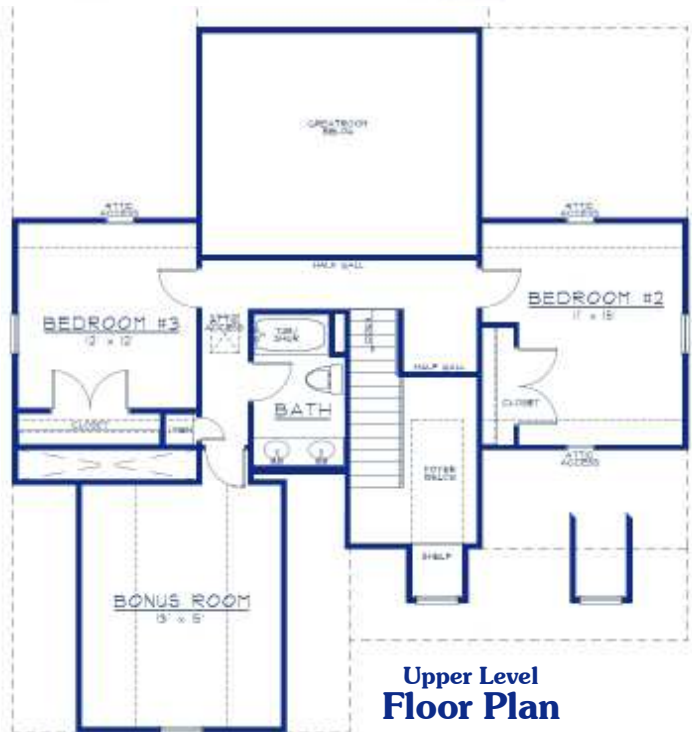

Upper Level Floor Plan

PROPRIETARY INFORMATION:

The furnishing of this information does not convey any reproduction or construction rights. This brochure is provided as general information for choosing your new home. Refer to blueprints and specifications for accurate details. Timber Truss Housing Systems, Inc. reserves the right to introduce changes in plans and specifications without notification or obligation. Timber Truss Housing Systems, Inc.

TrussMark Homes
by TIMBER TRUSS HOUSING SYSTEMS, INC.
P.O. Box 996 • 525 McClelland Street
Salem, Virginia 24153-0996
Phone 540/387-0273 • 800/766-9072
Fax 540/389-0849 www.timbertruss.com